

# CITY OF LOS ANGELES

CALIFORNIA

TONY M. ROYSTER  
GENERAL MANAGER  
AND  
CITY PURCHASING AGENT



KAREN BASS  
MAYOR

Agenda Item No. 4

DEPARTMENT OF  
GENERAL SERVICES  
ROOM 701  
CITY HALL SOUTH  
111 EAST FIRST STREET  
LOS ANGELES, CA 90012  
(213) 928-9555  
FAX No. (213) 928-9515

March 30, 2023

Matthew W. Szabo, Chair  
Municipal Facilities Committee  
200 North Main Street, Suite 1500  
Los Angeles, CA 90012

## **REQUEST FOR SPACE ASSIGNMENT – ADDITIONAL STORAGE SPACE FOR THE DEPARTMENT OF TRANSPORTATION (LADOT) AT 1111 MATEO STREET, LOS ANGELES, CA 90021**

---

The Los Angeles Department of Transportation (LADOT) requests the assignment of approximately 25,080 square feet (sf) of unassigned warehouse space at 1111 Mateo Street, Los Angeles, CA 90021.

While the Council authority for the lease specified that it was for LADOT use, the original program for LADOT revealed that there would be more space than what was needed for LADOT. The unassigned space at 1111 Mateo Street was previously under consideration to address the file storage needs of other City Departments such as the Office of the City Clerk. However, those needs have been addressed and the space is no longer needed to store files.

LADOT can fully utilize the unassigned space to address the critical storage needs of multiple LADOT divisions. The additional space will be utilized as-is to store and secure various materials, items, and equipment that are instrumental to the operation of multiple LADOT programs such as Vision Zero, Active Transportation, LA AI Fresco, Signal Field Operations, and more.

### **BACKGROUND**

LADOT currently utilizes approximately 19,240 square feet for office and storage space at the 1111 Mateo Street warehouse. In addition, they currently store various materials, items, and equipment at another warehouse located at 1201 Mateo Street, Los Angeles, CA 90021.

The LADOT Equipment Repair Shop, currently located at 430 East Commercial Street, will relocate to 1201 Mateo Street. The Department of General Services (GSD)



Construction Forces Division will begin the final phase of construction work and improvements at the 1201 Mateo Street location to accommodate the Equipment Repair Shop. Materials, items, and equipment for these other LADOT divisions are temporarily stored at 1201 Mateo Street but need a permanent home. Once assigned, LADOT will be able to move the materials and equipment from 1201 Mateo Street to 1111 Mateo Street so that GSD Construction Forces can complete the necessary work at 1201 Mateo Street.

The following items are included in this report as attachments:

- Diagram and floor plan of the 1111 Mateo Street warehouse (outlines the areas to be utilized by each division)
- List of different types of materials and equipment to be moved (not all-inclusive)
- Photographs of materials and equipment (not all-inclusive)

Pursuant to Council File 96-0426, the Department of General Services (GSD) has the authority to assign up to 5,000 square feet (sf) for City departments in City owned space and provide notification to the Municipal Facilities Committee (MFC). This space exceeds that amount and is within leased space. Therefore, GSD is requesting MFC approval to assign the remaining 25,080 sf to LADOT.

### **FISCAL IMPACT**

There is no additional impact on the General Fund at this time.

### **RECOMMENDATION**

That the Municipal Facilities Committee approves this Space Assignment for the Department of Transportation as substantially outlined in this report.

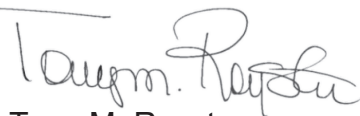

Tony M. Royster  
General Manager

Attachments: Floor Plan  
Types of Materials and Equipment  
Photographs

**OVERALL FLOOR PLAN**

**LOS ANGELES DOT TENANT IMPROVEMENT**  
1111 S. MATEO ST., LOS ANGELES, CA

**JAMES HEIMLER, ARCHITECT, INC.**  
19510 VENTURA BLVD., SUITE 210 (818) 343-5393  
TARZANA, CALIFORNIA 91356 FAX (818) 343-5815  
www.jhai-architect.com jheimler@jhai-architect.com

Job No. **2020-2001**

**OVERALL FLOOR PLAN** SCALE: 1/16"=1'-0"

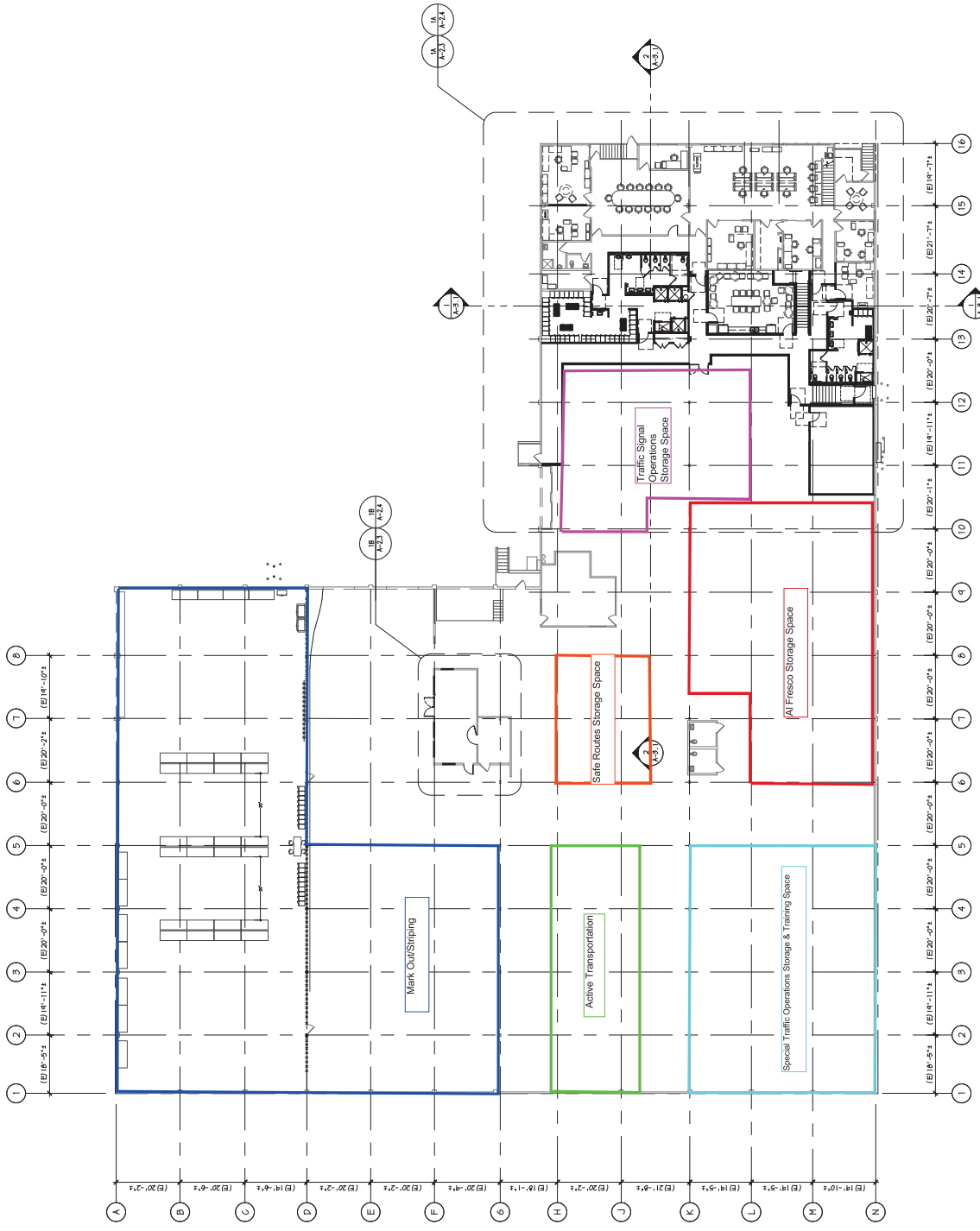

# **Types of Materials, Items, and Equipment**

## **(Not All-Inclusive)**

### **Vision Zero**

- Up to 500 pieces ZICLA vectorial platforms (ranges from 1.5' x 1.5' to 2' x 0.5')
- Possibly store an assembled platform measuring 60' x 7' approximately 500 bollards at a time (29" H x 8" W each)
- RRFB units up to 50 sets (boxes at least 2' x 2')
- 25 RRFB cabinet/solar panels (25" W x 25" H x 2" D)
- Approximately 25 radar speed signs measuring 33" H x 30" W x 6" D
- Approximately 100 modular speed bumps measuring 13" x 11" x 2"
- Approximately 25 modular traffic island units measuring 4' x 4'

### **Markout/Striping Support for Various LADOT Programs**

- 1080 K-71 white bollards, 18 pallets
- 540 K-71 yellow bollards, 9 pallets
- 500 White T-curb with bollards, 3 pallets
- 500 Yellow T-curb with bollards, 3 pallets
- 200 Black/yellow tough bumps (rubber speed bumps), 3 pallets
- 500 Paddle signs with bases, 4 pallets
- Preform thermoplastic - various legends, 25 pallets

### **Active Transportation**

- 9 Pallets of bollards 29" H x 8" W each, 60 per pallet
- 13 Bike shape racks, 65" long x 42" tall
- 9 Pallets of bike racks, 25 racks per pallet
- 2 Pallets of parking blocks, 6'
- 1 Pallet of parking blocks, 3'

- 2 Pallets of cycle hoops
- 5 Pallets of K72 (40 in each pallet)
- 3 Bike corrals

### **LA AI Fresco**

- Approximately 200 pieces of water K-rail. Each piece is approximately 80 lbs. and the dimensions are 6' L x 18" W x 32" H
- Up to 40 planters, 30" H, 64 lbs. each
- Approximately 80 shade umbrellas and bases
- Approximately 100 bollards, 29" H x 8" W each

### **Signal Field Operations**

- Traffic signal LED modules - approximately 50 to 75 pallets (42" x 52")
- Traffic signal controller cabinets - approximately 10 to 20 on pallets (30" x 40")
- Traffic signal heads

W235419  
4 OF 23

96 12"  
RB

8-18 688

**TSR LED REFILL  
PALLET  
DO NOT TAKE  
FROM THIS  
PALLET**

LED Signals

LED Signals

LED Signals

LED Signals

LED Signals

LED Signals



MODEL D18  
MANUF X778-VLA

MODEL D18  
MANUF X778-VLA

MODEL D18  
MANUF X778-VLA

120 V  
12" TINTED  
REFILL  
MODEL D18  
MANUF X778-VLA

12 TINTED  
REFILL  
MODEL D18  
MANUF X778-VLA

12 TINTED  
REFILL  
MODEL D18  
MANUF X778-VLA













01/08/2021 12:30 PM 87°F

 VOSKER